

THIS DRAWING CONTAINS INFORMATION PROPRIETARY TO RF INDUSTRIES.  
 ANY UNAUTHORIZED USE OF THIS DRAWING IS EXPRESSLY PROHIBITED  
 WITHOUT WRITTEN PERMISSION FROM RF INDUSTRIES.  
 ANY VIOLATION IS PUNISHABLE UNDER U.S. COPYRIGHT LAWS.

ALL DIMENSIONS ARE REFERENCE ONLY

PART NO.

**RQA-5010-C1**

REV	DESCRIPTION	DWN	DATE	APPROVED
-	ENGINEERING RELEASE	CZS	04/13/07	JDMc
A	ADD PRESS CAP NOTES	CZS	06/19/07	JDMc
B	ADD STRIPPING DIMENSIONS	CZS	06/23/08	JDMc

NOTE: PRESS CAP TO BE PRESSED INTO THE BODY CAVITY AFTER ATTACHING CABLE.

NOTE: ATTACH CABLE TO CONNECTOR BY  
 SOLDERING THE CABLE CENTER CONDUCTOR  
 TO THE PIN SLOT INSIDE THE CONNECTOR CAVITY.

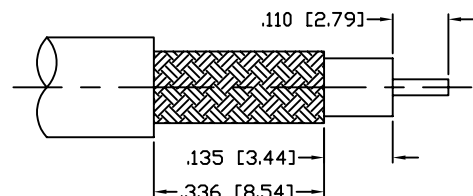

RECOMMENDED STRIPPING INSTRUCTIONS

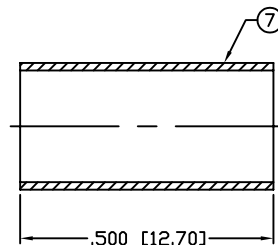

RECOMMENDED CRIMP DIE: .213"

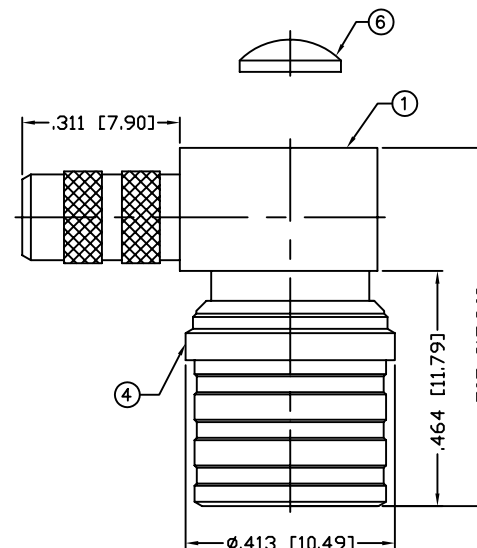

**\*\*USE QMA TOOL TO PRESS THE END CAP (ITEM 6)  
 INTO THE BODY TO AVOID DAMAGE TO THE SPRING  
 RFI PART NUMBER "QMA-TOOL"**

**SPECIFICATIONS:**

IMPEDANCE: 50 Ohms  
 FREQUENCY RANGE: 0-6+ GHz  
 INSULATION RESISTANCE: 5k M Ohms min.  
 TEMPERATURE RANGE: -65°C TO 165°C  
 FOR RG-55, 55A, 55B, 142, 142A, 142B, 223 & 400/U,  
 ALPHA 9055, 9055B, 9223, BELDEN 8219, 83242, 84142

1	BODY	1	BRASS	COPPER, TIN, ZINC	008974	
2	INSULATOR	1	PTFE	----		
3	GROUND RING	1	WHITE BRONZE	COPPER, TIN, ZINC		
4	SHELL	1	BRASS	COPPER, TIN, ZINC		
5	PIN	1	BRASS	GOLD, 30μ"		
6	PRESS CAP	1	BRASS	COPPER, TIN, ZINC		
7	FERRULE	1	BRASS	COPPER, TIN, ZINC		
8						
9						
10					DRAWN	
11					C. ZUNIGA	06/23/08
12					CHECKED	
13					ORJ DRAWN	
14					C. ZUNIGA	05/05/05
#	DESCRIPTION	QTY	MATERIAL	FINISH	APPROVALS	DATE

UNLESS OTHERWISE SPECIFIED:

DIMENSIONS ARE IN INCHES  
 AND [MILLIMETERS]  
 UNLESS OTHERWISE NOTED  
 TOLERANCES ARE:

DECIMALS      DIAMETER

**RF connectors**  
 DIVISION OF RF INDUSTRIES, LTD.

7610 MIRAMAR RD  
 SAN DIEGO, CA 92126  
 (858) 549-6340  
 (858) 549-6345 FAX

**QMA PLUG, CRIMP**

RIGHT ANGLE

SIZE	CABLE GROUP	DWG NO.	REV
A	C1	RQA-5010-C1	B

SCALE: NTS

CAD FILE OUTLINE

SHEET 1 OF 1